

## Feature

- 125 PSI (400 CWP)
- 1-piece brass body
- FNPT x FNPT
- Threaded ends (ASME B1.20.1-NPT)
- Chrome plated ball
- ANSI Z21.15 / CSA 9.1
- CSA 1/2, 5 & 125 psi
- ASME B16.44/CSA9.4
- ASME B16.33 / CAS 3.16



## Material

	Part	Material	Specification
1	Body	Brass	UNS C37700
2	Seat	PTFE	Commercial grade
3	Ball	Brass / Cr plated	UNS C37700
4	Cap	Brass	UNS C37700
5	Screw	Plated Steel	ASME SA6
6	Stem	Brass	UNS C37700
7	O-ring	NBR	Commercial grade
8	Handle	Aluminum	ANSI A380
9	Packing	PTFE	Commercial grade
10	O-ring	NBR	Commercial grade

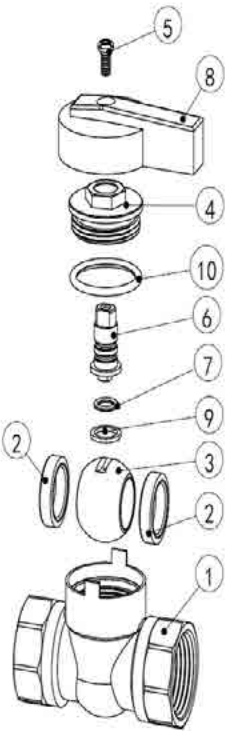

## Dimension, Weight

Size	T	W [in]	H [in]	L [in]	DN [in]	C [in]	Wt. [lb]
3/8"	3/8 - 14 NPT	2.03	1.42	1.38	0.39	0.47	0.26
1/2"	1/2 - 14 NPT	2.36	1.42	1.38	0.39	0.61	0.34
3/4"	3/4 - 14 NPT	2.60	1.54	1.48	0.59	0.63	0.60
1"	1 - 14 NPT	3.11	1.78	1.81	0.75	0.75	1.01

