

STAINLESS STEEL TWO HOLE STRAP

Features:

- Manufactured in type 316 stainless steel to meet any stringent sanitary condition
- Polished with standard “brite” finish to increase corrosion resistance and aesthetic appearance
- Designed for use with stainless rigid, stainless IMC, galvanized and aluminum conduit
- No package quantity required



Applications:

Heavy duty type 316 stainless steel two-hole mount straps are great for securing and mounting conduit, tubing and cable in corrosive environments.

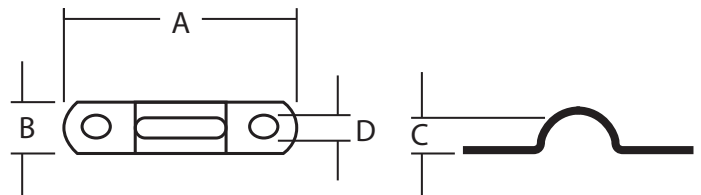

Part Number	Trade Size (in)	A (in)	B (in)	C (in)	Bolt Hole Size (in)	Weight per each (lb)
S605002S00	½	2.630	0.630	0.840	¼	0.020
S607002S00	¾	2.930	0.750	1.050	¼	0.030
S610002S00	1	3.380	0.750	1.300	¼	0.040
S612002S00	1¼	4.350	0.820	1.660	¼	0.060
S615002S00	1½	4.440	1.240	1.900	¼	0.130
S620002S00	2	5.300	1.250	2.370	¼	0.170
S625002S00	2½	5.750	1.250	2.870	¼	0.200
S630002S00	3	6.800	1.250	3.500	¼	0.230
S640002S00	4	9.75	1.250	4.500	¼	0.280

All dimensions are for informational purposes only *Tolerances +/- 5%

