

## STAINLESS STEEL X CONDUIT BODIES

### Features:

- Manufactured in type 316 stainless steel to meet any stringent sanitary condition
- Polished with standard “brite” finish to increase corrosion resistance and aesthetic appearance
- Solid stainless construction permits easy installation using ordinary hand tools
- The flat back design allows extra wiring capacity
- No package quantity required
- Cover and Gasket set included
- Form 8 style
- FDA Approved, white neoprene gaskets
- Use of hex head cap screws helps prevent any harboring points



### Certifications and Compliances:

- UL / cUL 514A Listed
- UL File # E307133
- Article 314 of ANSI/NFPA 70, National Electrical Code (NEC)
- Approved for wet locations, IP69 Rated
- NSF/ANSI 169 Certified
- 21CFR175.300 / FDA approved neoprene gasket

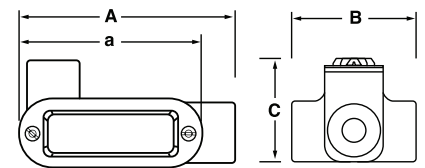

### Materials:

- Body: 316SS
- Gasket: Neoprene
- Cover and Screws: 316SS

### Applications:

To connect and change direction of conduit runs. Can be used as pulling fittings. Accessible wiring chamber provides a spacious location to make splices.



Part Number	Trade Size (in)	A (in)	B (in)	C (in)	a (in)	Cubic Inches (in)	Weight per each (lb)
S60500XB00	½	5.994	2.944	2.050	4.320	5	1.44
S60700XB00	¾	6.538	3.398	2.300	4.950	9	2.04
S61000XB00	1	7.690	3.910	2.450	5.650	13	2.79
S61200XB00	1¼	8.780	4.300	2.825	6.600	24	4.24
S61500XB00	1½	9.923	4.640	3.060	7.810	35	5.41
S62000XB00	2	12.554	5.810	3.700	10.000	77	9.45

All dimensions are for informational purposes only \*Tolerances +/- 5%

