

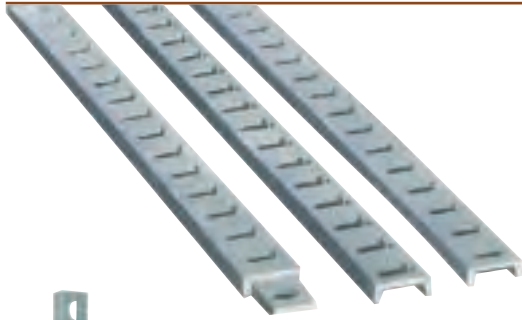

# MANHOLE EQUIPMENT & ACCESSORIES



## Cable Racks

Supports cable runs in manholes and vaults. Made of 1½" x 9/16" x 3/16" (38 x 14 x 5 mm) hot rolled steel channel, hot dip galvanized. T-slots for attaching hooks are spaced at 1½" (38 mm) intervals. The 8, 14 and 18 hole racks have 19/32" x 3/4" (15 x 19 mm) mounting slots at each end that interlock so two or more racks may be combined into one unit. Longer racks are mounted through the T-slots. Use ½" or M12 mounting hardware (see pg. 121).

Part Number	Support Holes	Length		Bolt Hole Spacing	
		(in)	(mm)	(in)	(mm)
08380000	8	15	381	13½	343
08380100	14	24	610	22½	572
08380200	18	30	762	28½	724
08380300	37	55¼	1,403	-	-
08380400	43	64¼	1,631	-	-
08383500	47	70¼	1,784	-	-

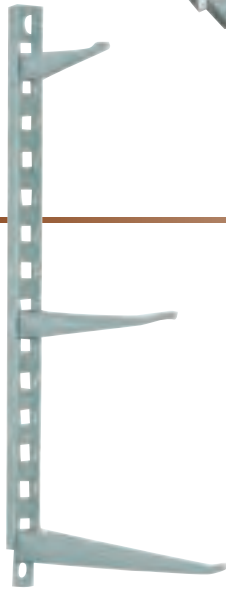

## Cable Rack Hooks

Designed to fit snugly into the rack slots. Turned up ends prevent cable or rack insulators from slipping off. Manufactured from 3/16" (5 mm) steel and hot dip galvanized with smooth surfaces to prevent cable damage. Cable rack hooks load rated to 300 lbs.

Part Number	Ext.	
	(in)	(mm)
08380600	4	102
08380700	7½	190
08380800	10	254
08380900	14	356
08381000	18	457

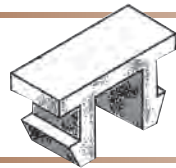

## Plastic Retaining Clip

Part Number	Description
08381210	Plastic Retaining Clip

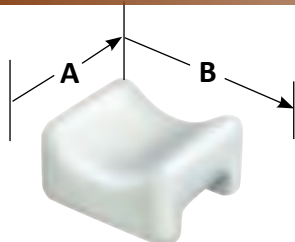

## Cable Rack Insulator

Made of glazed porcelain, the insulators rest on the cable rack hooks, providing additional protection for the cable.

Part Number	Groove Radius		Groove (A) Width		Groove (B) Width	
	(in)	(mm)	(in)	(mm)	(in)	(mm)
08381200	1½	38	2¾	70	3	76

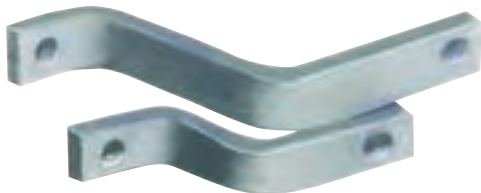

## Cable Rack Support

To extend the racks away from the wall and avoid obstructions or water seepage. Each rack requires two supports. Hot dip galvanized. Use ½" or M12 mounting hardware (see pg. 121).

Part Number	Steel Size		Ext. from wall	
	(in)	(mm)	(in)	(mm)
08381500	.5 x 1.00	13 x 25	3⅞	89
08383900	.5 x 1.00	13 x 25	6⅞	165
08383800	.5 x 1.25	13 x 32	6⅞	165



## Corner Rack Support

To bolt the racks at manhole corners. Mounting bolt holes for ½" or M12 bolts (see pg. 121). Formed of 1½" x ¼" (38 x 6 mm) steel and hot dip galvanized.

Part Number	Description
08383700	9" x 12" (228 x 305 mm) legs
08383600	12" x 12" (305 x 305 mm) legs