



# BREAK-AWAY SWIVELS



**!** The 10% break tolerance zone for pins used in 5/8" (16 mm) and 7/8" (22 mm) diameter break-away swivels is + / - 5% of the nominal break load, called out along with the swivel diameter, in the description of the pin.

## Break-Away Swivels

Essential for fiber optic and coaxial cable pulling, these swivels have a break load ranging from 150–1,800 pounds (667–8,006 N) and are designed to separate at ±5% of their rated break load. If the load rating is exceeded, the interior break pin fractures, the swivel separates, and the cable remains undamaged. Break pin is easily replaceable (see ordering information, next page).

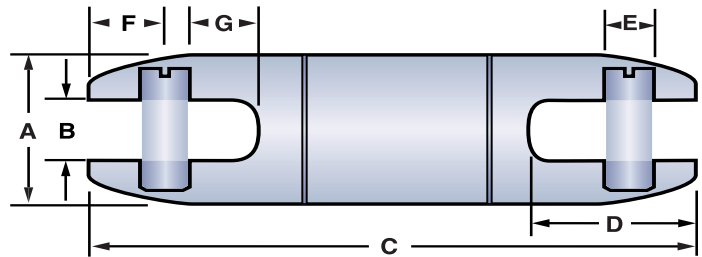

**NOTE:** Swivels are not designed to run around bullwheels.

	Part Number	Break Load		DIMENSIONS													
		(LBS.)	(N)	A	B	C	D	E	F	G							
				(IN.)	MM	(IN.)	MM	(IN.)	MM	(IN.)	MM	(IN.)	MM	(IN.)	MM		
5/8 Swivels	08017300	200	890	5/8	16	.28	7	3.56	90	.80	20	.16	4	.37	9	.34	9
	08017400	250	1,112	5/8	16	.28	7	3.56	90	.80	20	.16	4	.37	9	.34	9
	08016900	450	2,002	5/8	16	.28	7	3.56	90	.80	20	.16	4	.37	9	.34	9
	08017200	600	2,669	5/8	16	.28	7	3.56	90	.80	20	.16	4	.37	9	.34	9
	08017500	650	2,891	5/8	16	.28	7	3.56	90	.80	20	.16	4	.37	9	.34	9
	08017900	750	3,336	5/8	16	.28	7	3.56	90	.80	20	.16	4	.37	9	.34	9
7/8 Swivels	08018100	150	667	7/8	22	.38	10	4.41	112	1.03	26	.31	8	.53	13	.35	9
	08018300	200	890	7/8	22	.38	10	4.41	112	1.03	26	.31	8	.53	13	.35	9
	08018000	250	1,112	7/8	22	.38	10	4.41	112	1.03	26	.31	8	.53	13	.35	9
	08017600	300	1,334	7/8	22	.38	10	4.41	112	1.03	26	.31	8	.53	13	.35	9
	08018400	350	1,557	7/8	22	.38	10	4.41	112	1.03	26	.31	8	.53	13	.35	9
	08075300	400	1,779	7/8	22	.38	10	4.41	112	1.03	26	.31	8	.53	13	.35	9
	08015800	450	2,002	7/8	22	.38	10	4.41	112	1.03	26	.31	8	.53	13	.35	9
	08076500	500	2,224	7/8	22	.38	10	4.41	112	1.03	26	.31	8	.53	13	.35	9
	08018500	550	2,446	7/8	22	.38	10	4.41	112	1.03	26	.31	8	.53	13	.35	9
	08015000	600	2,669	7/8	22	.38	10	4.41	112	1.03	26	.31	8	.53	13	.35	9
	08018600	650	2,891	7/8	22	.38	10	4.41	112	1.03	26	.31	8	.53	13	.35	9
	08076000	700	3,114	7/8	22	.38	10	4.41	112	1.03	26	.31	8	.53	13	.35	9
	08075500	750	3,336	7/8	22	.38	10	4.41	112	1.03	26	.31	8	.53	13	.35	9
	08018700	800	3,558	7/8	22	.38	10	4.41	112	1.03	26	.31	8	.53	13	.35	9
	08018800	850	3,781	7/8	22	.38	10	4.41	112	1.03	26	.31	8	.53	13	.35	9
	08076600	900	4,003	7/8	22	.38	10	4.41	112	1.03	26	.31	8	.53	13	.35	9
	08015700	1,000	4,448	7/8	22	.38	10	4.41	112	1.03	26	.31	8	.53	13	.35	9
	08018900	1,100	4,893	7/8	22	.38	10	4.41	112	1.03	26	.31	8	.53	13	.35	9
	08015200	1,200	5,338	7/8	22	.38	10	4.41	112	1.03	26	.31	8	.53	13	.35	9
	08019100	1,300	5,782	7/8	22	.38	10	4.41	112	1.03	26	.31	8	.53	13	.35	9
08074600	1,400	6,227	7/8	22	.38	10	4.41	112	1.03	26	.31	8	.53	13	.35	9	
08076900	1,500	6,672	7/8	22	.38	10	4.41	112	1.03	26	.31	8	.53	13	.35	9	
08019200	1,600	7,117	7/8	22	.38	10	4.41	112	1.03	26	.31	8	.53	13	.35	9	
08019300	1,700	7,562	7/8	22	.38	10	4.41	112	1.03	26	.31	8	.53	13	.35	9	
08017700	1,800	8,006	7/8	22	.38	10	4.41	112	1.03	26	.31	8	.53	13	.35	9	